

Sony Venice - Camera Control via Ethernet Cable

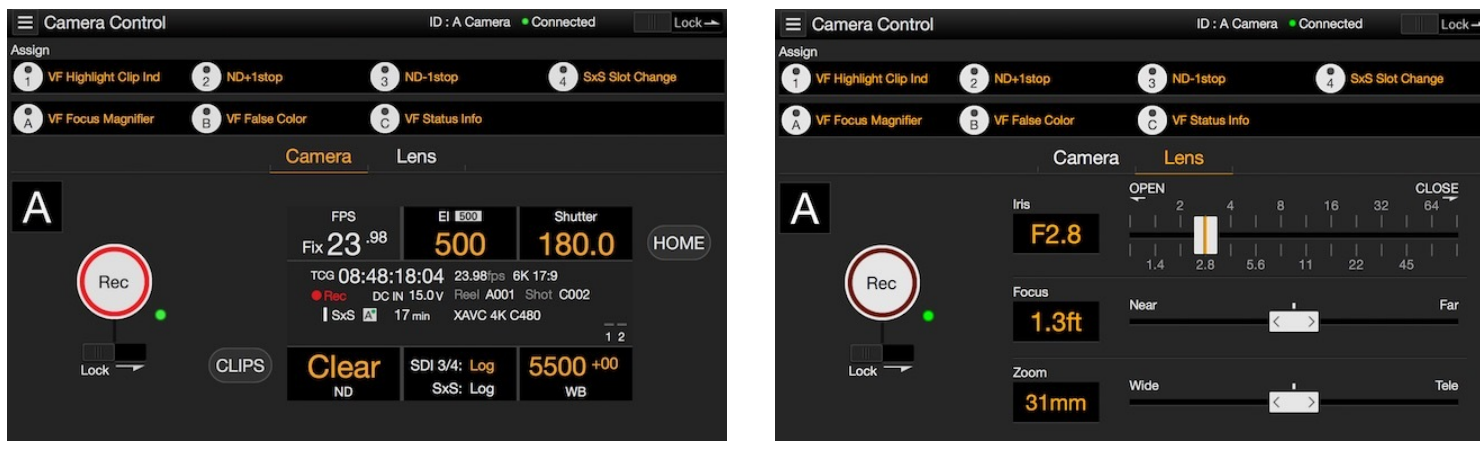
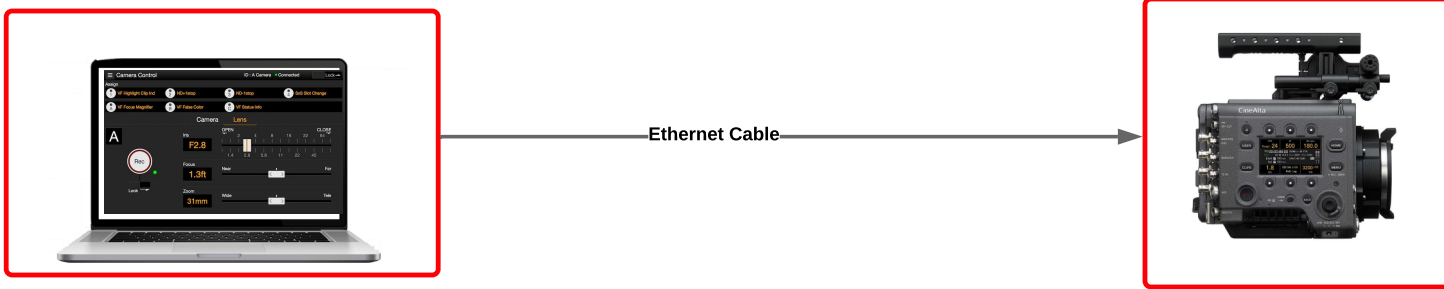

The Sony Venice can be network controlled over cabled Ethernet using the 'Camera Control' panel in a web browser. 100ft or longer cables

- Camera Control options available:**
- Run/Stop and Playback (*No Video Signal in Camera Control)
 - Frames per second
 - Assignable Buttons (Pre-Programmed)
 - Exposure Index
 - Shutter Angle
 - ND Filters
 - SDI outputs
 - Look/LUT Select
 - White Balance
 - Focus, Iris, Zoom (with compatible lenses)
 - Reel number
 - Timecode
 - OSD parameters
 - Audio Monitor Levels

* Media cannot be formatted

Set Up:

Connect Ethernet cable between laptop and Sony Venice

Sony Venice Setup:

- Technical > Authentication > Set **Username** and **Password**
- Technical > Network > Network Setting > Set to **LAN**
- Technical > Network > LAN > Turn **DHCP** off.
- Technical > Network > LAN > Change IP address to **192.168.0.1**
- Technical > Network > LAN > Ensure subnet mask is **255.255.255.0**

Laptop Setup:

- System preferences > Network > Find the ethernet port or adapter > Configure IPv4 > Select **Manually**
- Set the IP Address to **192.168.0.2** (last digit should be sequential one number higher than camera IP)
- Set the Subnet mask to **255.255.255.0**
- Click "**Apply**" to save settings.

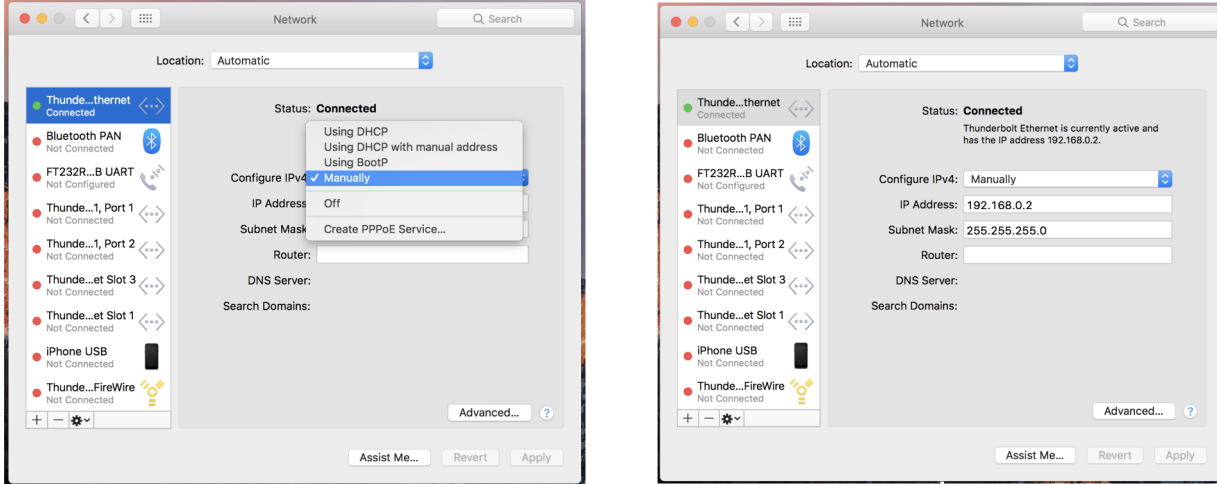

Copy the 'Camera' IP Address (**192.168.0.1**) into a web browser.
 Enter the Sony Venice **Username** and **Password** in Web UI.
 The Sony Camera Control panel will open and will be connected to the camera